

PERFORMANCE. OPTIMIZED.

The DHR Series offers an ideal solution for anyone ready to step up their sound reinforcement game to a new level of professional quality, accuracy, and performance. Premium plywood cabinets finished in a tough polyurea coating provide durability not found on other loudspeakers in this class. Each model in the series has been optimized to meet the demands of a variety of sound reinforcement applications, with a 10" model for fixed installation and utilities, a 12" model designed for use as a floor monitor, and a 15" version for FOH applications—all featuring custom transducers driven by DSP-equipped class-D power amplifiers to deliver stunning sound quality and clarity. Combined with practical features adapted for their specific applications, the series gives you the flexibility to choose the ideal speaker for a wide variety of sonic environments. Isn't it time you audition DHR quality and performance to improve your sound?



High-Efficiency 1000W Class-D Amplifiers

The DHR's lightweight, high performance Class-D amplifier is capable of producing up to 1000W* of power, achieving an SPL of 131dB, delivered with remarkable clarity and dynamic characteristics.

*DHR10 has an output level of 700W.



Custom Designed Transducers

The high power output woofers deliver well-defined, powerful bass with minimal distortion, while the 1.4" precision compression driver* produces accurate mid-range and high frequencies.

*DHR12M features a 1.75" coaxial compression coaxial driver.



12" coaxial driver

A Rugged, Highly Portable Cabinet

The DHR series feature plywood enclosures like our acclaimed DZR loudspeakers to deliver outstanding durability and acoustic performance.



Cabinet designs optimized for a range of audio environments

The DHR Series features a comprehensive lineup of powered loudspeakers with cabinets optimized to meet the demands of specific applications. The 10" model is equipped with rotating horns and a dedicated U-bracket for use in fixed installations and utility, while the 12" model is the first Yamaha speaker to feature a coaxial compression driver for improved clarity and smoother frequency response for floor monitoring. The series is rounded out by a 15" model featuring dual-angle pole sockets and rigging points for use in fixed installations or as temporary main speakers for sound reinforcement.



DHR10



DHR12M



DHR15

Easy-to-use Onboard 2-Channel Mixer

DHR Series speakers have two input channels. CH1 has a combo jack which accepts either XLR and TRS Phone allowing

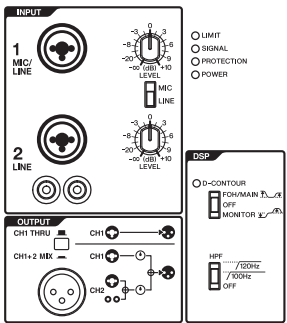

Mic or Line level input signals. CH2 offers two input options; a combo jack that accepts XLR or TRS Phone, and a pair of RCA pin Jacks for input from CD players or other stereo line-level sources. The onboard mixer allows you to select either CH1+2 MIX to mix the signal of CH1 and CH2, or CH1 THRU to pass the signal from CH1 only.

Dual-Angle Pole Mount Socket (DHR15)

DHR15's pole mount socket offers two positions—0° and 7°—to direct the acoustic energy away from reflective surfaces in a room with low ceilings and on to your audience where it belongs.



	Power Rating ¹	Maximum SPL ²	Frequency Range (-10dB)	LF	HF	Coverage Angle
DHR15	1000W	131dB SPL	44Hz-20 kHz	15" Cone	1.4" diaphragm, 1" throat	H90° x V60°
DHR12M	1000W	129dB SPL	55Hz-20kHz	12" Cone (coaxial with HF)	1.75" diaphragm, 1" throat	H90° x V60°
DHR10	700W	127dB SPL	52Hz-20kHz	10" Cone	1.4" diaphragm, 1" throat	H90° x V60° (Rotatable)

¹Dynamic power ²Measured Maximum SPL (peak)