



DELIVERED THE ORIGINAL SOUND



MODEL : CS-630
6" COAXIAL CEILING LOUDSPEAKER





FEATURES

- High Performance 2-way speaker
- Good for high music demand applications

SPECIFICATION

MODEL NO.	CS-630
Power At 100v	30W : 30W / 15W / 7.5W / 8Ω
Power At 70v	15W : 15W / 7.5W / 3.8W / 8Ω
Spl (1w / 1m)	88 dB
Max. Spl@1m	102 dB
Freq.response	90Hz-20 KHz
Cusout Size	Dia 230mm.
Product Size	Dia 203x90mm(H).X150mm(H).
Installation	Inceiling
Enclosure Material	ABS
Weight	1.6kg.
Finish	White
Speakers	1"x1 (Treble) 6"x1(Bass)

WARNING

This symbol indicates that dangerous voltage constituting a risk of electric shock is present within this unit.

This symbol indicates that there are important operating and maintenance instructions in the literature accompanying this unit.

1. FOR OUTDOOR USE:

To reduce the risk of fire or electric shock, do not expose this apparatus to rain or moisture.

2. UNDER WET LOCATION:

Apparatus should not be exposed to dripping or splashing and no objects filled with liquids, such as vases should be placed on the apparatus.

3. SERVICE INSTRUCTIONS:

CAUTION - These servicing instructions are for use by qualified service personnel only. To reduce the risk of electric shock, do not perform any servicing other than that contained in the operating instructions unless you are qualified to do so.



INSTALLATION

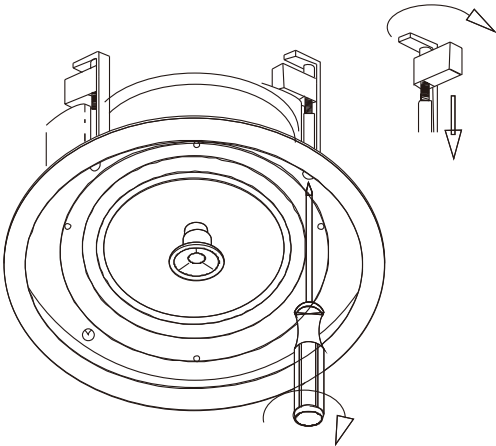

MOUNTING

