

Dimension:

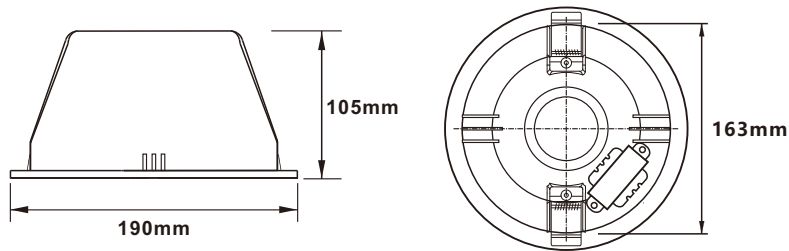

Installation Steps:

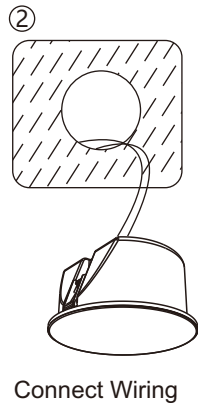
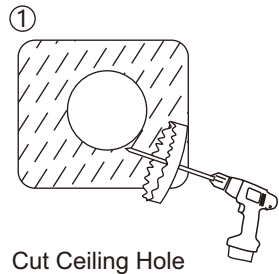
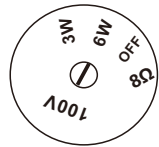

- DO NOT USE IN POSITION 8Ω ON A 100V SYSTEM, OR DAMAGE WILL OCCUR.

- RED WIRING: SIGNAL(+)
- BLUE WIRING: COM(-)

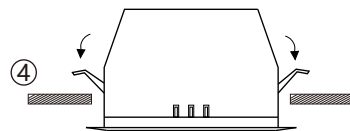
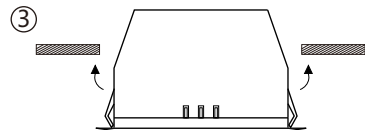

Retract the 2 Snap Clamps on the speaker into their open position. Then push the speaker up through the ceiling opening. When Clamp Arms press against the ceiling, the Snap Clamps will rotate and clamp down closed to the ceiling surface.

When inserted correctly, both 2 SnapClamps will be in the snap down position, thus securing the speaker securely into position in the ceiling.

CSI-06



Ceiling Speaker

User's Manual

Thanks for using our speaker products. All our products are tested strictly before leaving the factory, with guaranteed quality.

Our speakers are widely used in such places as schools, gymnasiums, square halls, parks, parking lots, railway stations, airports, villa communities and mall supermarkets, etc., and they will be your ideal choice for public address system.

For better installation, commissioning and use of the product, please read this manual in detail before installation.

Safety Tips

- Please be sure to use the former reading detailed notes.
- Really pay attention to this manual and a safety with the important warning.
- Recommend that you keep this manual for future reference.

Common warning signs and security

The manual shown warning signs and security is to prevent the improper operation due to personal injury arising from the loss of property, please read before using this product must understand that this manual security symbols and Warning to indicate fully aware of potential risks.

Warning
 Such as the inappropriate use of staff will cause injury, death and property damage.

When installed loudspeakers

- Definitely will not be allowed to speakers and any exposure in the rain-wet or water, may be inconsistent with ,or fire.
- Restricted by the provisions of the speakers on the voltage, such as the us of high voltage may cause electric shock or fire disaster. Is no pruning, distorted, or replacement of damaged wires.
- Avoid instability in the installation or set up speakers, such as shaking the table or flat surface , the speaker can avoid falling caused personal injury or property damage.
- Speakers will be installed in support of the speaker or the weight of a solid shelf. Speaker swap can be avoided caused personal injury or property damage.
- Wet hands must not be admitted into or plugs, may lead to electric shocks.
- The allocation of plugs, make sure that pull plugs, rather than pull wires.
The use of a damaged power line of machinery may cause fire or electric shock.
- Mobile speaker, you plug the prior allocated. If the speaker and plugs may be moving together will cause fire or electric shock. For plugs, identified as plugs for grip.
- Will not be allowed to speakers on the vent cover, may cause internal heating caused by the fire.
- Avoid speakers installed in the humidity or dust, direct contact with the sun from the near-electric, or smoke or steam, may cause fire or electric shock

Description and Feature:

CSI-06 6-inch ceiling speaker 6Watts is ideal for indoor applications requiring high-quality sound. designed for a wide range of commercial line transformers with multiple for use in 100V Taps at 100V: 3W, 6W and 8Ω/6W

Applications designed suitable, such as hotels, restaurants, bars, lounges, training and conference rooms, or shopping centers.

- 6-inch ceiling loudspeaker for installation
- Elegant design.
- Easy to installation.
- High-quality sound.
- Frequency response 110Hz~15KHz.
- Transformer taps 100V: 3W, 6W,6W/8Ω.

Specification:

Speaker type	Ceiling loudspeaker
Rated power	3W, 6W
Line voltage	100V
Transformer taps	100V: 3W, 6W,6W/8Ω
Frequency response	110Hz ~15kHz (-3dB)
Sensitivity 1W/1m	90 ±3dB
Maximum SPL/1m (calc)	97 dB
Coverage (Nominal -6 dB)	H160° (±5°)
Coverage (Nominal -6 dB)	V150° (±5°)
Speaker driver	6-inch
Nominal impedance (Passive)	8Ω
Operating temperature	-20 °C to +55 °C
Connections	A length of connecting cable
Indoor applications	Yes
Color	White
Cabinet material	ABS enclosure
Front grille	Metal grille
Dimensions hole for mounting	Φ165mm
Dimensions	Φ190 x H 105 mm (without bracket)
Weight	1.47Kg