

ENGLISH

Escort® 5000

Portable Pro Audio System

Congratulations! You have just purchased the world's finest portable PA system. The Escort's integrated design allows for ease of transport, while its user-friendly controls offer ease of operation, making it the perfect choice for schools, churches, civic organizations as well as DJ's and small musical groups. The Escort features dual two-way speakers driven by a seven-channel, powered mixer, making it ideal for vocal, musical and DJ applications. The mixer includes a media channel with several inputs for multiple playback options, as well as professional quality features such as a digital effects section, footswitchable effects defeat and a master seven-band graphic EQ with FLS® (Feedback Locating System). The carrying case provides additional storage for microphones, cables and whatever optional gear may be required. The Escort's case provides latches for mounting for speakers, multiple handles for various carrying options, and wheels for easy transport. Please read these instructions carefully and enjoy your new Peavey Escort 5000.

Features:

- Convenient package with luggage-style wheels
- Two-way speaker system with 10" woofer and piezoelectric horn
- Eight-channel powered mixer
- USB MP3 playback
- High quality digital effects
- 7x XLR - 1/4" combination inputs
- Stereo RCA, 3.5mm, and USB media inputs for media playback
- Seven-band graphic EQ with FLS
- Two folding speaker stands
- 2x 15' speaker cables
- Sub-woofer out
- Monitor line level out
- Storage compartments for microphones, cables, etc.
- Footswitchable effects defeat
- PV microphone and cable*
- Mixer stand*

* Indicates optional features. Available on certain models

Setup Guide

THINK SAFETY FIRST!



Much of the setup of the Escort® is similar to the setup of other sound systems, and many aspects require plain common sense. Safety should always be your first concern. Always use grounded outlets and three-wire extension cords. Run sound system cables in a way to prevent the danger of tripping and tape them down if needed. Place the speaker stands and mixer on a solid, level surface. Following these guidelines will help prevent personal injury and equipment damage, ensuring years of trouble-free use.

Setting Up Mixer and Speakers

Place closed unit so speakers are upward. Release latches by lifting up until the latch disengages. Remove the speakers from the case.

NOTE: The latches can be closed after speakers are removed. This is recommended to avoid interference with removal of other components. This will also help avoid damage to the latches. Close the latch by pushing in until it is flush with the side of the case, then push down until it locks.

Remove the speaker stands from the case. Be sure the legs on the stand are fully extended to provide a stable base for the speakers and are positioned on a level surface. Tighten the thumbscrew on the base so that it is snug, but do not overtighten (Fig.1). Raise the speaker stands to the desired height, tighten the thumbscrew and install the safety pin as shown (Fig.2).



Fig. 1

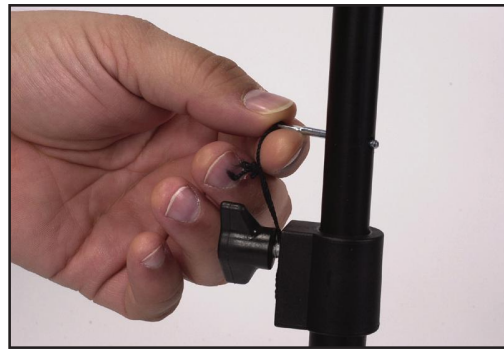
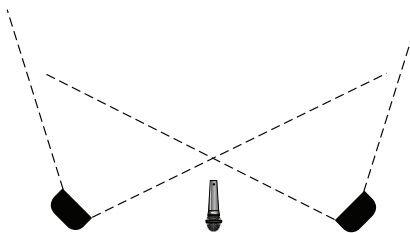

Fig. 2

Place speakers on stands and position them so that they will face toward the audience and away from the microphones (Fig.3). Connect speaker cables from the jack on the lower front of the speaker to the speaker outputs on the back of the mixer. Connect the left speaker to the LEFT OUTPUT and the right speaker to the RIGHT OUTPUT (Fig.4).



OR

Fig. 3

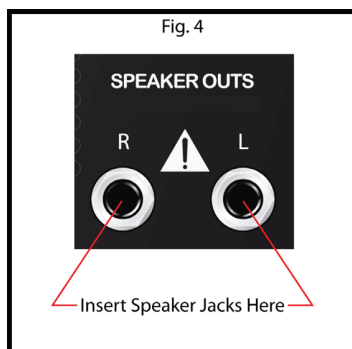
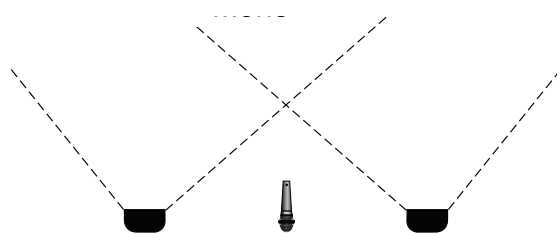

WARNING! Only connect the included speakers to the mixer. Escort speakers provide optimal load for the powered mixer and using other speakers may result in equipment damage.

Connecting a Powered Sub-Woofer

The Escort 5000 features a Sub-Woofer output that is internally crossed over at 100Hz. This output is line level so it will need to be connected to a POWERED Sub or a Power Amplifier that will then drive your passive Subs. Be sure the power for your Escort and your Sub-Woofer is turned OFF. Insert a 1/4" shielded cable into the Sub-Woofer Output (Fig.5) on the back of the Escort, then insert the other end of the shielded cable into your POWERED Sub-Woofer or power amplifier input.

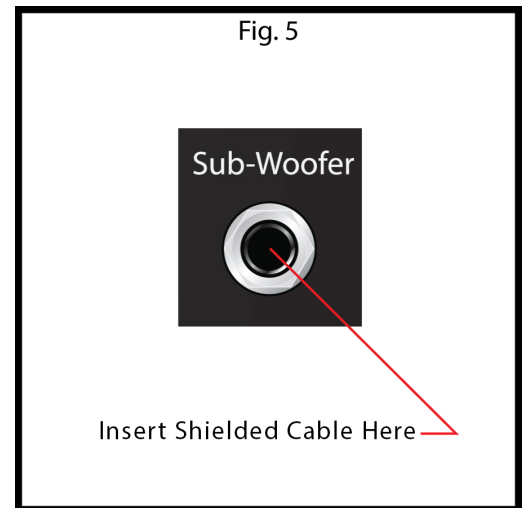

Connecting a Monitor

The Escort 5000 includes a full-range line level Monitor output. This is to be used when monitors are required for a performance. This output is line level so you will need to use POWERED Monitors or a separate power amplifier to drive passive monitors. Be sure the power to your Escort and your Monitors is turned OFF. Insert a 1/4" shielded cable into the Monitor Output on the back of your Escort (Fig.6), then insert the other end of the shielded cable to the input on your POWERED Monitors or power amplifier. This output can also be sent to another mixer or recording device to record the full-range signal from your performance. The level of the monitor mix can be controlled by the master monitor control (Fig. 6a).

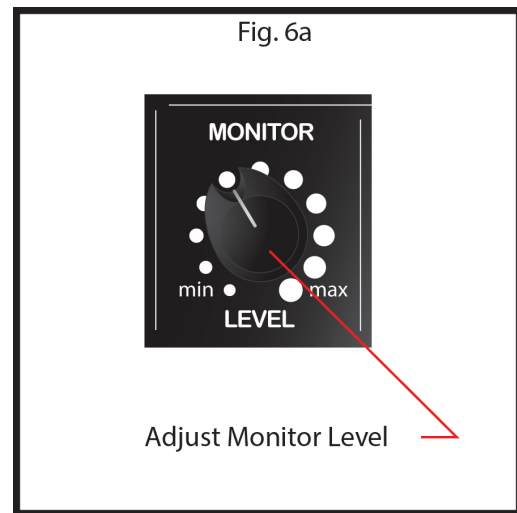
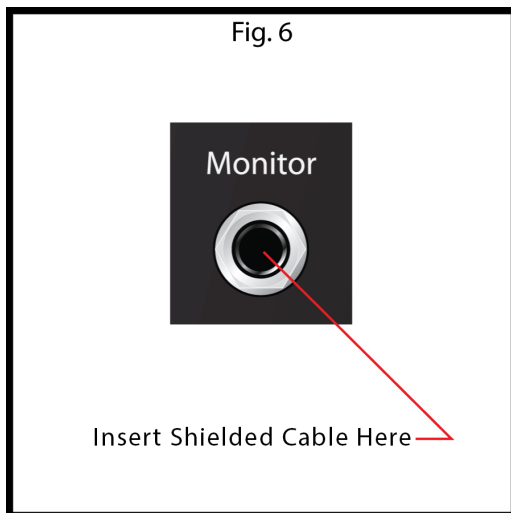

Connecting Microphone(s) or Line Input(s)

The Escort's powered mixer is designed to work with any good-quality, balanced, dynamic or condenser microphone such as Peavey's PV'i series of microphones. Connect the microphone to the XLR (three-pin) input connector as shown (Fig.7). If using multiple microphones, connect them in the order they will be on stage for easy adjustment to each microphone. To connect a line level device such as a keyboard, use a 1/4" instrument cable and insert into the center of the XLR-1/4" combo connector as shown (Fig.8).

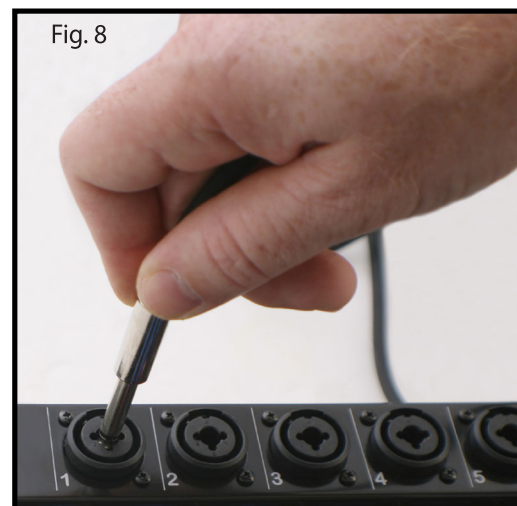
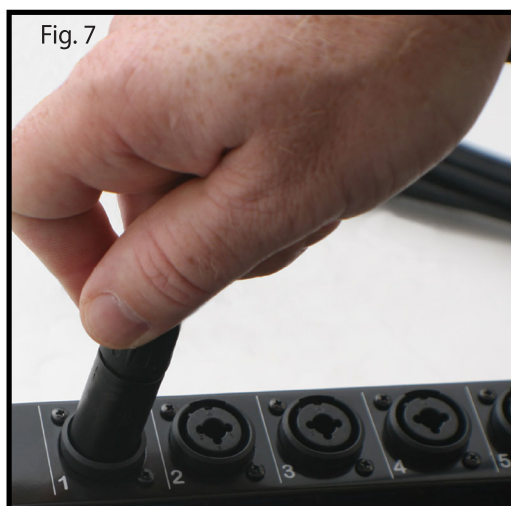

Connecting Media Playback Sources

The Escort powered mixer will accept various media playback devices. For connecting a CD player or grounded record player use the CHANNEL 8 RCA Left and Right connections. For connecting an MP3 player or smartphone with media playback use the 3.5mm stereo connector. This will require a stereo 3.5 mm cable (03007820) which can be found at your local Peavey dealer. When using a USB memory stick with MP3 or other audio files stored on it, insert the memory stick into the USB connector on CHANNEL 8 and use the screen and controls in the master section to navigate and play back audio files (Fig.9).

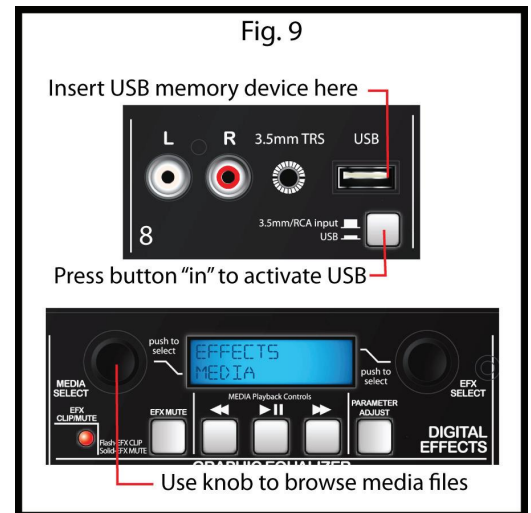

Connecting Power

WARNING! Before connecting power make sure the power switch is in the OFF position.

Connect the IEC power cord to the receptacle on the back panel of the unit as shown (Fig.10), and then to a suitable electrical outlet. If an extension cord is required, make sure it is a three-wire cord with an intact ground pin to preserve the safety ground.

NOTE: FOR UK ONLY

As the colours of the wires in the mains lead of this apparatus may not correspond with the coloured markings identifying the terminals in your plug, proceed as follows: (1) The wire that is coloured green and yellow must be connected to the terminal that is marked by the letter E, or by the Earth symbol, or coloured green or green and yellow. (2) The wire that is coloured blue must be connected to the terminal that is marked with the letter N, or the colour black. (3) The wire that is coloured brown must be connected to the terminal marked with the letter L, or the colour red.

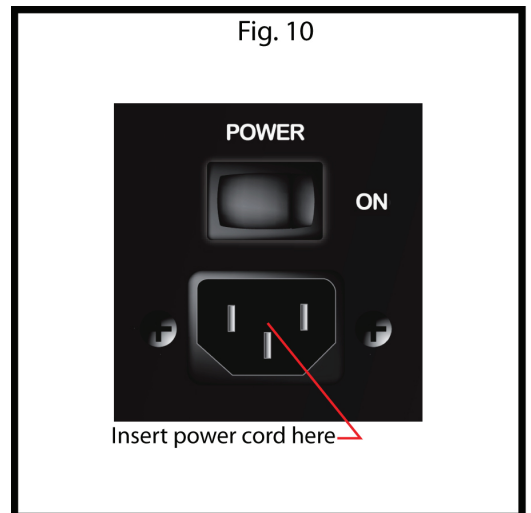

Basic Operation:

Setting Controls and Turning Unit On

Before turning on power, make sure all speakers, microphones, and other input devices are connected. Set Master section controls to the 12 o'clock position and all other controls all the way down (rotated fully to the left). Turn power on by placing the ON/OFF switch located on the back of the mixer (Fig.11) in the ON position.

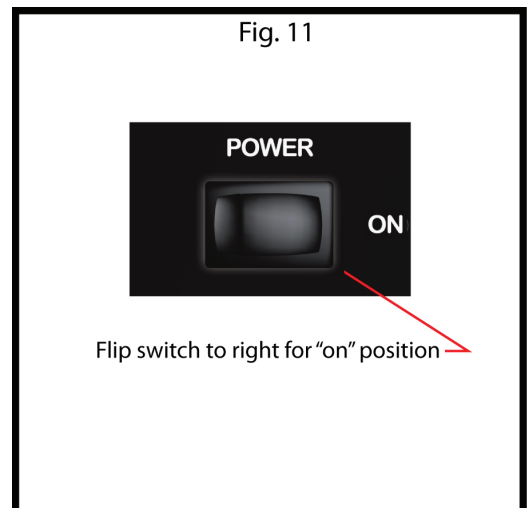

Basic Operation:

Adjusting Gain and Volume Controls

The optimal setting for the powered mixer and included speakers is marked on the MASTER LEVEL control (Fig.12). Adjust the CHANNEL LEVEL control (Fig.13) until the desired volume is achieved. If the desired volume is reached with the CHANNEL LEVEL turned down to one of the first three positions, turn the MASTER LEVEL down so you can turn the CHANNEL LEVEL up. If the desired volume is achieved when the CHANNEL LEVEL is close to max then raise the MASTER LEVEL so you can lower the CHANNEL LEVEL. These are the same as any basic mixer functions.

Adjusting Tone Controls

For each active channel adjust the HIGH, MID-MORPH®, and LOW controls to achieve desired sound. Use moderation when making these adjustments, as extreme high settings of any of these controls can lead to a distortion of the sound and an increased chance of feedback on microphone inputs.

HIGH

This High EQ shelving type of active tone control varies the treble frequencies (+/- 15dB at 12kHz) and is designed to remove noise or add brilliance to the signal, depending on the quality of the source.

MID-MORPH

Where most mid-range controls work at just one frequency, the Mid-Morph works at two. When turned to the left, it cuts at 250 Hz to reduce frequencies that muddy the sound. When turned to the right, it boosts at 4 kHz to add intelligibility to vocals. Either way, improved vocal or instrument definition can be achieved.

LOW

A shelving type of EQ that varies the bass frequency levels (+/- 15dB at 80Hz). Low EQ adds depth to thin-sounding signals or cleans up the muddy ones. As with any EQ, use sparingly. Too much of this EQ can give you a booming bottom end.

Fig. 12



Open circles indicate optimal range

Fig. 13



Tone Controls

Channel Level Control

Effects:

Adjusting Effect Settings

The Escort has built-in digital effects. These effects can be selected in the MASTER section by turning the EFFECTS SELECT knob left or right until the desired effect is shown on the display (Fig.14). Once the desired effect is displayed on the screen push the knob in to select and activate the effect. To adjust the effect parameter simply press the PARAMETER ADJUST button (Fig.14) the available parameter and its adjustments will be shown on the display. Turn the EFFECTS SELECT knob left or right to adjust the parameter then press the PARAMETER ADJUST button or the EFFECTS SELECT knob to return to the effects select screen. To hear more or less of the effect, on any given channel, turn the CHANNEL EFX knob to the left to hear less of the effect, and to the right to hear more of the effect (Fig.15). The EFX MUTE button in the master section (Fig.14) will mute the effects on all channels. There are no effects on the media channels.

Fig. 14



Press to MUTE effects on all channels

Press to enter Parameter Adjust mode

Turn knob to find effect, press knob "in" to select and activate effect

Effects:

Footswitchable Effects Defeat

Your new Escort has a footswitchable effects defeat. This allows the user to mute the effects on all channels by use of a single button footswitch such as the Peavey Momentary Single-Button Switch (03050680) which can be purchased at your local Peavey dealer. Insert the 1/4" plug from the footswitch into the EFFECTS DEFEAT jack on the rear of the Escort mixer (Fig.16). Once connected, pressing the footswitch button will toggle the EFX MUTE (Fig.14).

Available Effects and Parameters

ON SCREEN NAME	EFFECT	AVAILABLE PARAMETER
1 REV Plate Br1	Plate Reverb Bright	Time
2 REV Plate Br2	Plate Reverb Gentle Low-Pass	Time
3 REV Plate Med	Plate Reverb Medium Low-Pass	Time
4 REV Plate Dk1	Plate Reverb Hard Low-Pass	Time
5 REV Plate Dk2	Plate Reverb Dark	Time
6 REV Vocal	Hall Reverb Vocal	Time
7 REV Vocal Big	Hall Reverb Vocal Huge	Time
8 REV Vox Warm	Hall Reverb Vocal Glow	Time
9 REV Strings	Hall Reverb Strings	Time
10 REV Lg Brass	Hall Reverb Brass Hall	Time
11 REV Vox Air	Room Reverb Vocal Air	Time
12 REV Vox Club	Room Reverb Vocal Club	Time
13 REV Snare	Room Reverb Snare Low	Time
14 REV Ac Guitar	Room Reverb Acoustic Guitar	Time
15 REV Sm Brass	Room Reverb Brass	Time
16 ENH Tube	Enhancer Tube Distortion	Brightness
17 ENH Vocal 1	Vocal Enhancer Vox	Brightness
18 ENH Vocal 2	Vocal Enhancer Vox Medium	Brightness
19 DLY Double	Delay Double	Time
20 DLY Slap	Delay Slapback	Time
21 DLY BRT 1	Delay Bright, Few Repeats	Time
22 DLY BRT 2	Delay Bright, More Repeats	Time
23 DLY BRT 3	Delay Bright, Most Repeats	Time
24 DLY Dark 1	Delay Dark, Few Repeats	Time
25 DLY Dark 2	Delay Dark, More Repeats	Time
26 DLY Dark 3	Delay Dark, Most Repeats	Time
27 CHO Deep Slow	Chorus High Depth, Slow Rate	Rate
28 CHO Mod Wide	Chorus Moderate Depth, Wide Rate	Rate
29 CHO Shrt Wide	Chorus Short Depth, Wide Rate	Rate
30 CHO Shrt Fast	Chorus Short Depth, Fast Rate	Rate
31 CHO Deep Mod	Chorus High Depth, Moderate Rate	Rate

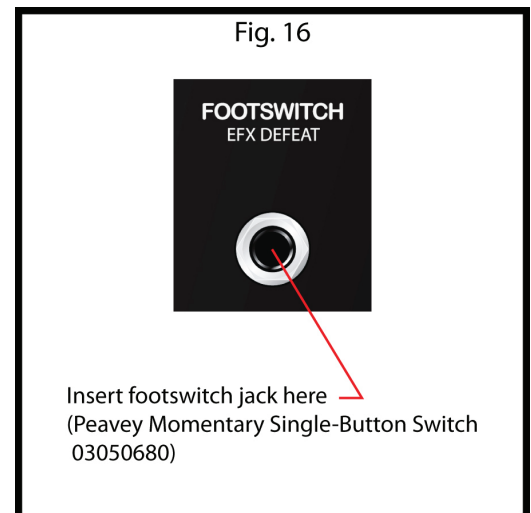
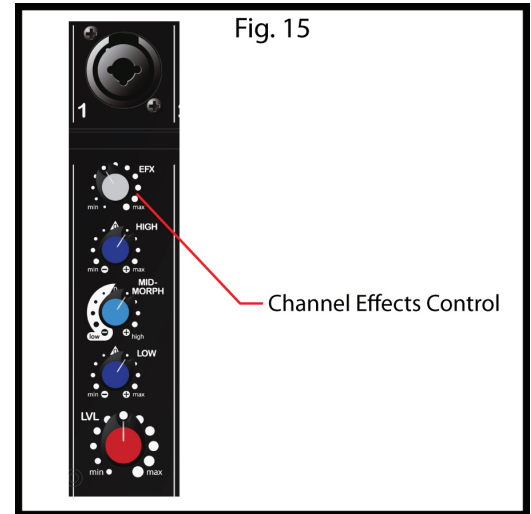

MEDIA:

Playback from Media Source

Hook up your media source device as mentioned previously. When using RCA jacks for a CD player, record player, or tape machine make sure the button is in the raised position so these jacks are active (Fig.17). Which inputs are active will also be displayed on the screen in the master section. Use the controls on the source device for play, stop, forward and reverse functions. Adjust channel controls on the Escort mixer for desired sound. For media playback using an MP3 player, smartphone, or other similar device make sure the button stays in the raised position. Connect using a stereo 3.5mm cable mentioned previously and use the source device for playback controls. When a device is connected to the 3.5mm jack the RCA jacks are automatically disabled. For MP3 or audio file playback from a USB memory stick, make sure the button is in the down position (Fig.18) so the USB plug is active.

NOTE: The Escort does not allow playback through multiple media inputs simultaneously.

With your USB device attached, use the MEDIA SELECT knob (Fig.19) to navigate through your audio files. Once the desired file is displayed on the screen press the MEDIA SELECT knob to cue that file. Use the controls on the mixer for play, pause, forward and reverse. If you do not choose to navigate or select a certain file the Escort will play the files in the order they are stored on your USB memory device.

Supported Audio File Types

.WAV
.MP3
.WMA

Fig. 17

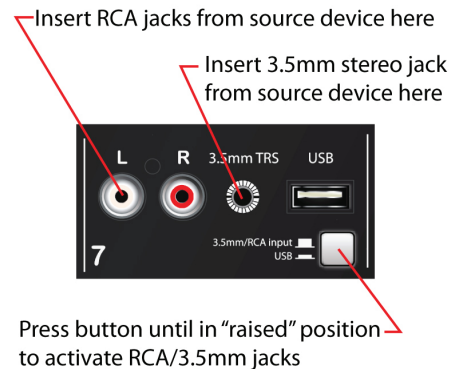

Fig. 18

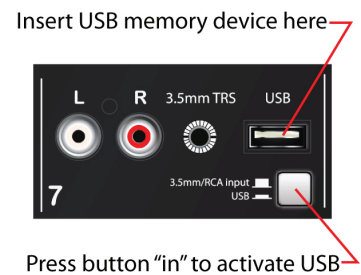

Fig. 19



EQUALIZATION:

Using the Graphic Equalizer

Unlike the HIGH, MID-MORPH, and LOW controls on each channel that adjust only the tone of their own input signals, the seven-band graphic equalizer adjusts the tonal balance of all the signals going through the powered mixer. This graphic equalizer is also a powerful tool to help reduce or eliminate acoustic feedback. This offers the user great flexibility in adjusting the sound, but use moderation in making these adjustments.

FLS® Feedback Locating System

The FLS (Feedback Locating System) LED indicators are invaluable tools in helping to reduce/eliminate feedback. Acoustic feedback is the loud howl or squealing sound heard through sound systems as the result of sound from the speakers re-entering the microphones. To use the FLS feature, start by setting all graphic EQ sliders (Fig. 20) to 0. Then before the audience arrives, increase the MASTER LEVEL and/or CHANNEL LEVEL until feedback occurs. Note which LED illuminates and slightly lower the corresponding slider. This reduces gain at the feedback frequency and can be repeated if necessary to improve gain before feedback. Only adjust the sliders a small amount to avoid adversely affecting sound quality.

Fig. 20

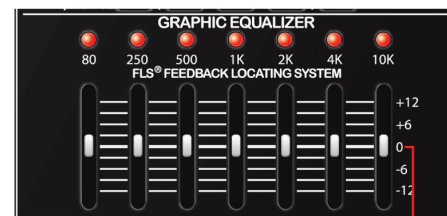

GENERAL USE TIPS:

Avoiding Acoustic Feedback

When encountering feedback it is always best to start looking at the placement of the mics and speakers in the system before resorting to equalization (EQ) adjustments. Make sure that the speakers are positioned to direct the sound toward the audience and away from the microphones. Position mics as close to the sound source as reasonable. Moving the mic closer increases the volume of the sound through the system without having to turn up the gain.

Microphone Usage Guidelines

When practical, a single microphone is preferred. Additional microphones pick up more sound from the speakers and each mic must then be turned down to prevent feedback. However, if you have difficulty balancing the level of different individuals with one mic or if you still cannot get sufficient gain, using more mics can offer an advantage. For example, giving several singers their own microphone allows placement of the microphones much closer to each singer. This increases the volume of the sound at the mic and far outweighs any detrimental effect from using multiple mics. It also allows the volume of each mic to be adjusted separately for proper balance.

Packing the Escort®

One of the Escort's many benefits is that the entire sound system can be packed inside its easily transportable case (Fig.21). Begin by folding the speaker stands, then secure them into their storage compartment using the two straps. Place the optional microphone(s) in their storage compartment, putting the cables in the other compartment or with the speaker stands. Lay the speakers face down on top of the bottom tray and secure the four latches. The Escort is now ready to be carried or pulled on its built-in, luggage-style wheels.

Fig. 21



OPTIONS:

Optional Accessories (available from local Peavey dealer)

Microphone Stands - Tripod mic stand with boom (00722910)

Additional Microphones and Cables - PVi® 2 mic with cable included (00496360)

Microphone Wind Screens - Black wind screen (00069100)

Additional Speaker Cables in Various Lengths - 25' 16 AWG (00060450)

Additional Speaker Stands in Various Sizes - Black Speaker Stand (00722890)

Audio Cables for CD Player, Record Player, Tape Machine, or MP3 Player/Smartphone Hook-up

Optional Mixer Stand Assembly (00496340)

Remove the mixer stand from the case. The mixer stand consists of three parts: two pairs of legs and the stand cross-members (Fig.22). Hold the stand cross-member with the leg sockets together as shown (Fig.23). Fully insert one set of legs into the cross-members (Fig.24). Still holding the cross members together, set the legs on the floor and insert the second pair of legs. If you need to move the stand, carry it folded by holding the legs.



WARNING: For safety, be sure to fully open the mixer stand and place it on a stable, level surface.

Fig. 22

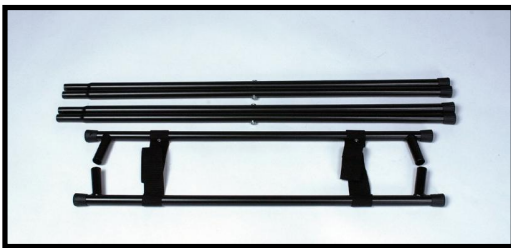

Fig. 23



Fig. 24



Escort® 5000 Troubleshooting Guide

Problem	Check	Correction
No sound (LCD not lit)	Is power switch on? Is line cord connected to live power outlet?	Turn power switch on Connect power cord to live outlet
No sound (LCD lit)	Are MASTER and CHANNEL GAIN controls up?	Adjust both MASTER and CHANNEL LEVEL controls upward to desired level. Check speaker connections. Turn mic switch on. Check mic or sound source connection.
No Effects	Are the channel EFX controls turned up? Is the master EFX MUTE enabled? Is an effect activated in menu?	Make sure desired effect is selected in Master effect menu. Check the master EFX MUTE. If the LED is illuminated the EFX MUTE is active. Press the EFX MUTE button once to disable. Adjust channel EFX control until audio effect is heard.
Files on USB memory device will not play back	Is the file cued for playback? Are the audio files the proper format?	Make sure once MEDIA SELECT knob is rotated to display desired file the knob is then pressed to cue the file. Make sure your audio files are the correct format. See the list of supported audio formats mentioned previously in this manual.
Loud howling or squeal from speakers	If it goes away when the CHANNEL or MASTER LEVEL controls are turned down, then it is acoustic feedback.	Reduce microphone gain. Reposition microphone behind or farther from speakers. Observe FLS light above EQ and reduce level of corresponding slider.
Sound is distorted	Is the CHANNEL GAIN at a very high setting?	Reduce CHANNEL GAIN and increase MASTER VOLUME

Escort® 5000 Specifications:

Output Power:	250 watts RMS (per channel)
Frequency Response:	40 Hz to 20 kHz +/-3 dB
Overload Protection:	10 dB of DDT™ that limits the PA output to prevent clipping that can damage the speakers
Distortion:	Less than 0.2% THD @ Max power
Signal/Noise Ratio:	88 dB mic input typical
AC Power:	115 V AC 60 Hz or 230 V AC 50/60 Hz
Weight Assembled: (stands included)	50 lbs. (22.67 kg)
Dimensions:	14.5" H x 36.75" W x 15.5" D (36.8 cm x 93.3 cm x 39.4 cm)
Speakers:	Woofer 10" (254 mm) Piezoelectric Horn Tweeter
Phantom Power:	15VDC Available on all XLR Inputs.